

NOTE: ALL STORM STRUCTURES/OUTLETS ARE TO HAVE RIPRAP OUTLET PROTECTION EXTENDING TO 0.0% GRADE AS SPECIFIED IN THE VESCH STANDARDS AND SPECIFICATIONS

NOTE: THE ENTIRE RIVERBEND APARTMENTS STORM SEWER SYSTEM WAS DESIGNED USING THE 10-YR STORM EVENT TO CONTAIN THE RUNOFF WITHIN THE PIPE AND STRUCTURES. IN ADDITION, THE 100-YR STORM EVENT WAS ROUTED THROUGH THE STORM SYSTEM. THE STORM SEWER SYSTEM ADEQUATELY CONTAINED THE 100-YR STORM HGL WITH LITTLE TO NO PONDING OUTSIDE OF STRUCTURES AND DOES NOT IMPACT THE APARTMENT BUILDINGS.

CROSS SECTION G-G : (WETLANDS HEADWATER @ CARRIAGE POINT RD & RIVERBEND APARTMENTS ENTRANCE)

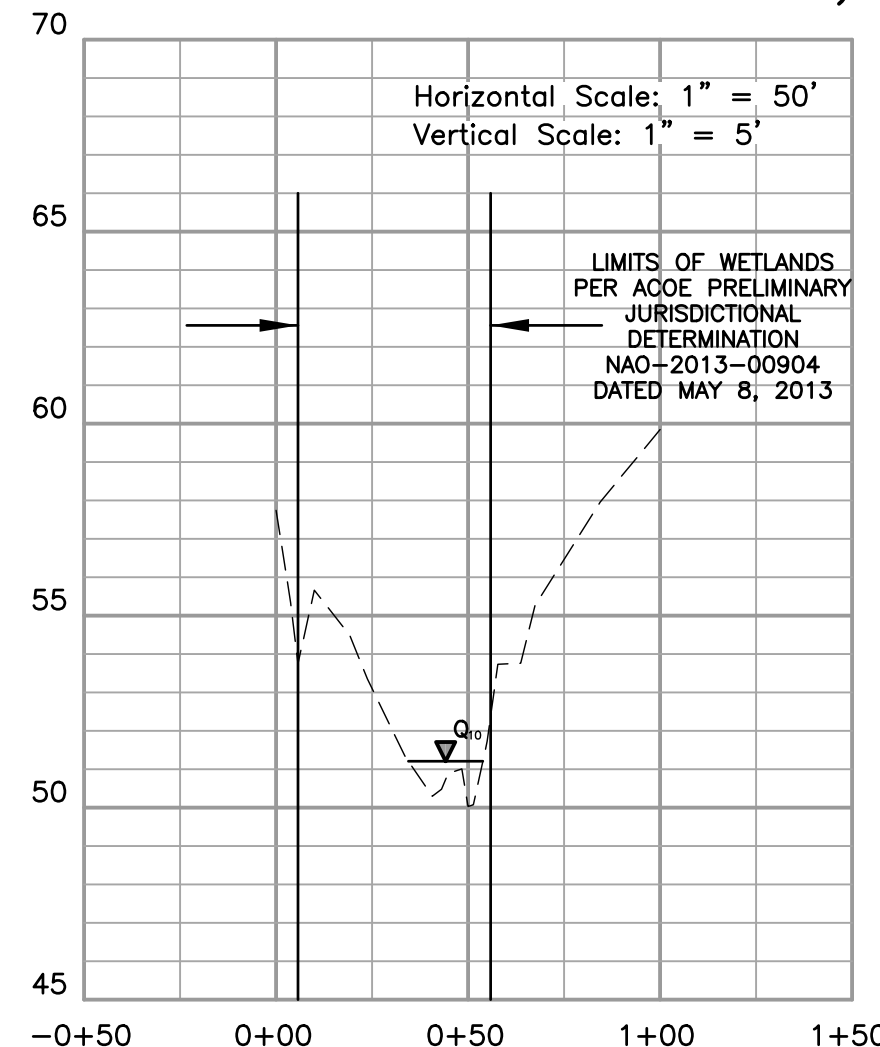

D.A. = 17.56 AC.
C_w = 0.59
T_{total} = 17.4 MIN.
I₂ = 3.54 IN/HR
I₁₀ = 4.72 IN/HR
Q₂ = (0.59)(3.54)(17.56) = 36.68 CFS
Q₁₀ = (0.59)(4.72)(17.56) = 48.90 CFS
V₂ = 3.97 FPS < V_{allowable} = 4.00 FPS (PER VESCH TABLE 5-14)
V₁₀ = 4.38 FPS
D₂ = 1.08'
D₁₀ = 1.18'

PROPOSED 12" C900 PVC WATERLINE BY ZANDLER DEVELOPMENT CO, LLC PER CARRIAGE POINT ENTRANCE PLAN DATED 7/18/18

PROPOSED 12" C900 PVC PER CARRIAGE POINT ENTRANCE PLAN BY ZANDLER DEVELOPMENT CO, LLC DATED 7/18/18

"ZANDLER WAY" (TO BE INSTALLED BY ZANDLER DEVELOPMENT CO, LLC PER CARRIAGE POINT ENTRANCE PLAN DATE 7/18/18)

BEGIN RIVERBEND DRIVE WITH CONNECTION TO CARRIAGE POINT DRIVE

PROPOSED 8" SANITARY SEWER EXTENSION BY ZANDLER DEVELOPMENT CO, LLC PER CARRIAGE POINT ENTRANCE PLAN DATED 7/18/18

END CONSTRUCTION RIVERBEND APARTMENTS SEWER AND BEGIN UPSTREAM SEWER EXTENSION BY ZANDLER DEVELOPMENT CO, LLC PER CARRIAGE POINT ENTRANCE PLAN DATED 7/18/18

PROPOSED 6'x12'x14'x2.0'D CLASS 1 RIPRAP @ EL. 54.0

PROPOSED 6'x6' E-3, TYPE B MATTING OUTLET PROTECTION

PROPOSED TEMPORARY RESIDENT PARKING AREA FOR MAIL PICK-UP

18'x21' CONCRETE PAD FOR ACCESSIBLE MAIL BOXES

MONUMENT SIGNS (SEE LANDSCAPE ARCHITECT PLANS PREPARED BY SISKIA AURAND LANDSCAPE ARCHITECTS DATED 02/16/2018)

PROPOSED BERM PER REZONING APPLICATION Z-13-01 (SEE SHEETS L1 & L2 FOR LANDSCAPING AT BERM CREST)

TAX MAP 39A(2) PARCEL 4H
JOHN W. & ANGELA M. SWISHER
INST. #07-6547
C.P.B. 3 @ PG. 52

TAX MAP 39A(2) PARCEL 3H
JOHN W. & ANGELA M. SWISHER
INST. #07-6547
C.P.B. 3 @ PG. 52

RFI #8 - GRADING AND DRAINAGE MODIFICATIONS 12/11/18

ADA GRADING MODIFICATIONS 03/15/19

TAX MAP 39A(2) PARCEL 2H
JOHN W. & ANGELA M. SWISHER
INST. #07-6547
C.P.B. 3 @ PG. 52

ALL SIDEWALKS SHALL HAVE A MAXIMUM RUNNING SLOPE OF 5% AND A MAXIMUM CROSS SLOPE OF 2%.

TAX MAP 39A(2) PARCEL 1H
RANDALL R. WILLIAMS LIVING TRUST
INST. #07-6709
C.P.B. 3 @ PG. 52

LEGEND:
IRON ROD FOUND OR
IRON PIPE FOUND
CONCRETE MONUMENT FOUND
IRON ROD OR PIPE SET
CONCRETE MONUMENT SET
POWER POLE
TJB
OUL
N/F
R/W
PP
EXISTING OVERHEAD UTILITY LINES
EDGE OF PAVEMENT
FACE OF CURB
TOP OF CURB
SIDEWALK
DOWNSPOUT
ROOF DRAIN
EDGE OF CONCRETE

Scale: 1" = 20'

JOB NO. 12211-14

THIS DRAWING IS THE PROPERTY OF BAY DESIGN GROUP AND IS NOT TO BE REPRODUCED OR USED FOR ANY PROJECT IN WHOLE OR IN PART WITHOUT EXPRESS WRITTEN PERMISSION.

PROJECT MANAGER: GLJ

DESIGNED: WAS

CAD: WAS

CHECKED: WBB

FILED:

DATE: JANUARY 10, 2018

REVISED: APRIL 20, 2018

REVISED: JUNE 25, 2018

REVISED: JULY 13, 2018

REVISED: JULY 18, 2018

REVISED: AUGUST 27, 2018



Engineering Surveying & Land Planning

www.baydesigngroup.com

40 CROSS ST., SUITE 100
P.O. BOX 51
URBANA, VA 23175
(804) 693-2993

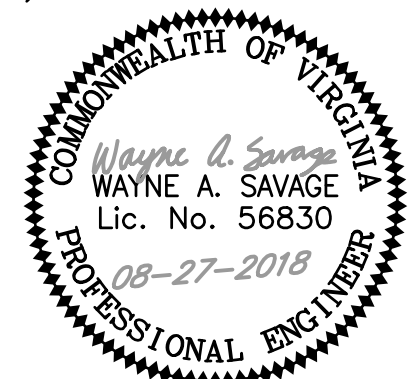

PROJECT:

RIVERBEND APARTMENTS

ABINGDON DISTRICT
GLOUCESTER, VIRGINIA

SHEET:

DETAILED GRADING PLAN

SHEET NO:

C7

JOB NO. 12211-14

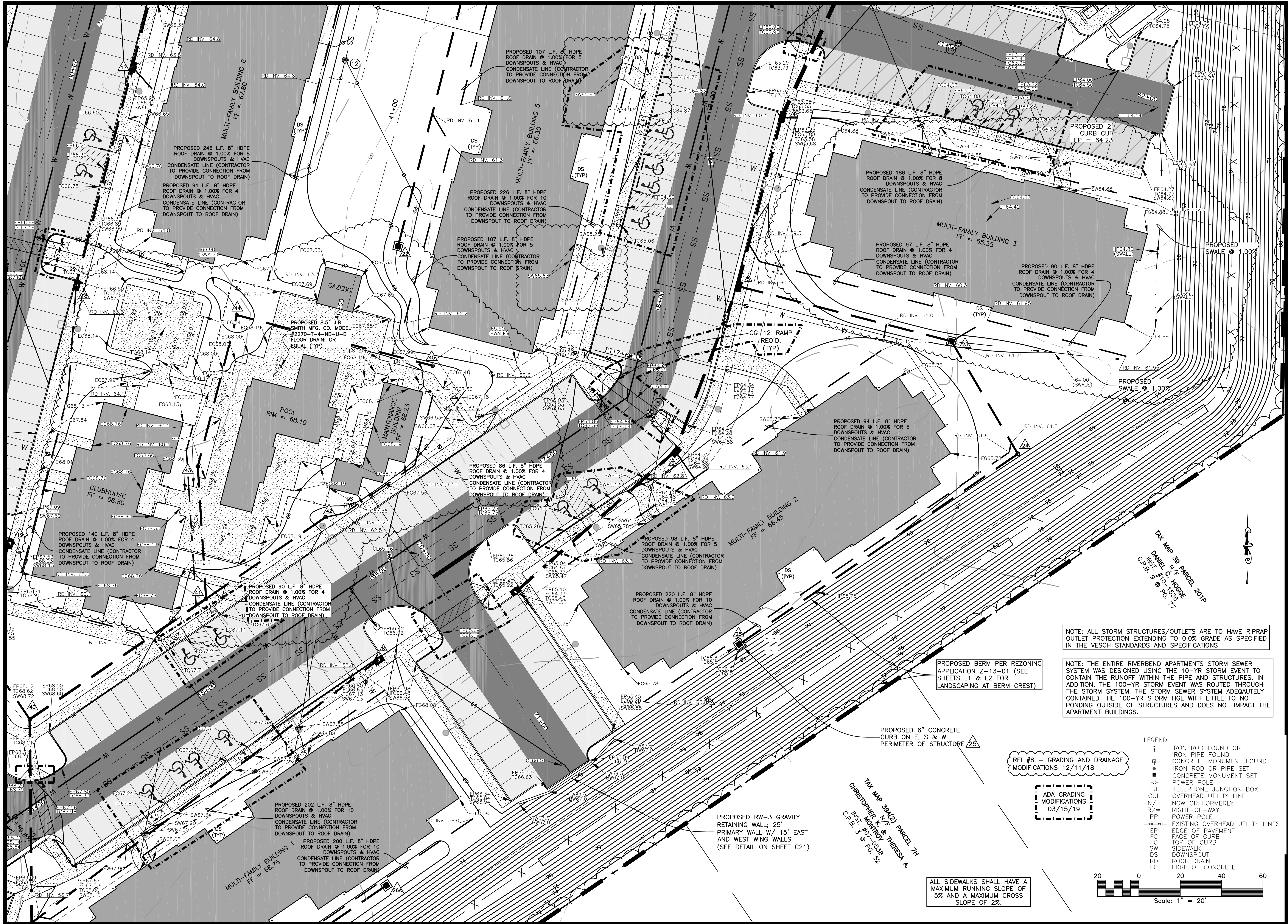

JOB NO. 12211-14

THIS DRAWING IS THE PROPERTY OF BAY DESIGN GROUP AND IS NOT TO BE REPRODUCED OR USED FOR ANY PROJECT IN WHOLE OR IN PART WITHOUT EXPRESS WRITTEN PERMISSION.

PROJECT MANAGER: GLJ

DESIGNED: WAS

CAD: WAS

CHECKED: WBB

FILED:

DATE: JANUARY 10, 2018

REVISED: APRIL 20, 2018

REVISED: JUNE 25, 2018

REVISED: JULY 13, 2018

REVISED: JULY 18, 2018

REVISED: AUGUST 27, 2018



40 CROSS ST., SUITE 100
P.O. BOX 51
URBANA, VA 23175
(804) 693-2993

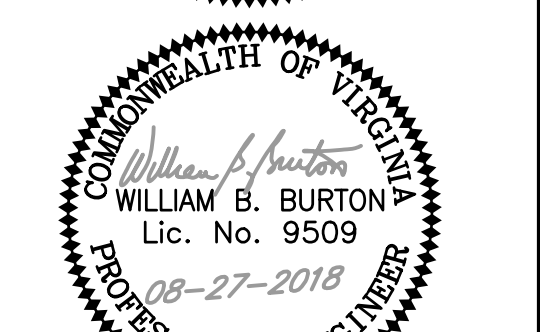
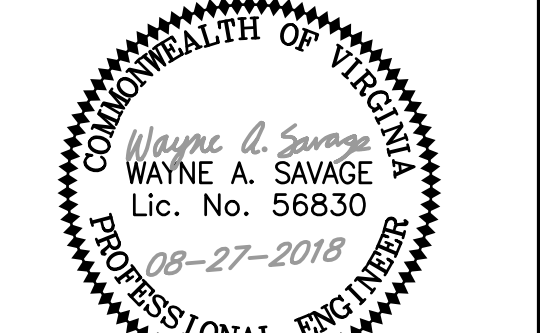

PROJECT:

RIVERBEND APARTMENTS

ABINGDON DISTRICT
GLOUCESTER, VIRGINIA

SHEET:

DETAILED GRADING PLAN

SHEET NO:

C8

JOB NO. 12211-14

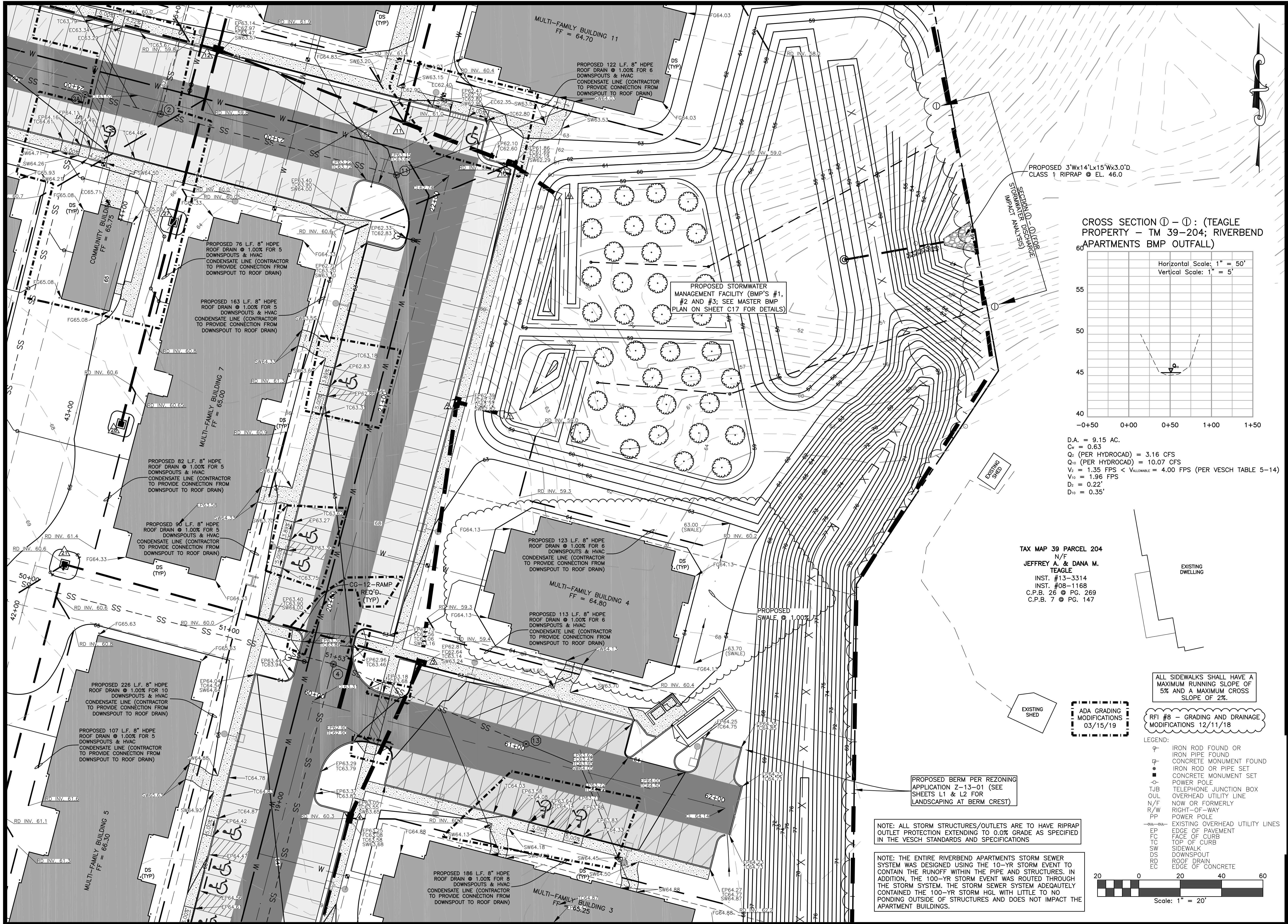

JOB NO. 12211-14

THIS DRAWING IS THE PROPERTY OF BAY DESIGN GROUP AND IS NOT TO BE REPRODUCED OR USED FOR ANY PROJECT IN WHOLE OR IN PART WITHOUT EXPRESS WRITTEN PERMISSION.

PROJECT MANAGER:

GLJ

DESIGNED: WAS

CAD: WAS

CHECKED: WBB

FILED:

DATE: JANUARY 10, 2018

REVISED: APRIL 20, 2018

REVISED: JUNE 25, 2018

REVISED: JULY 13, 2018

REVISED: JULY 18, 2018

REVISED: AUGUST 27, 2018



www.baydesigngroup.com

40 CROSS ST., SUITE 100
P.O. BOX 51
URBANA, VA 23175
(804) 693-2993

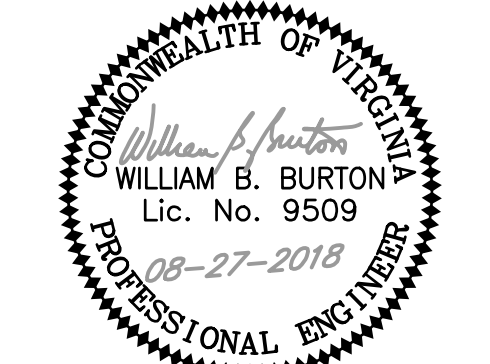
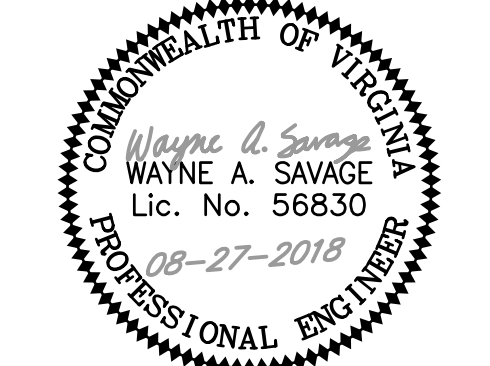

PROJECT:

RIVERBEND APARTMENTS

ABINGDON DISTRICT
GLOUCESTER, VIRGINIA

SHEET:

DETAILED GRADING PLAN

SHEET NO:

C9

JOB NO. 12211-14

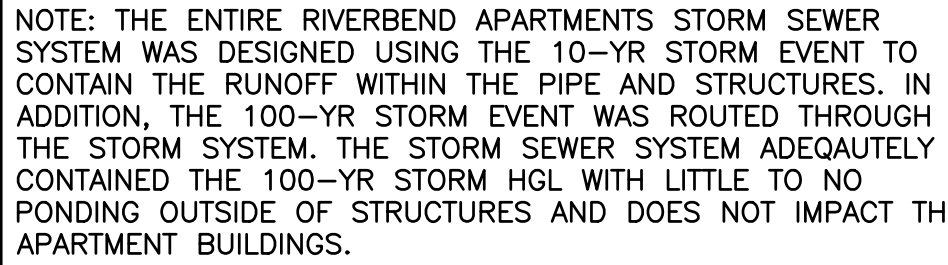

JOB NO. 12211-14

NOTE: ALL STORM STRUCTURES/OUTLETS ARE TO HAVE RIPRAP OUTLET PROTECTION EXTENDING TO 0.0% GRADE AS SPECIFIED IN THE VESCH STANDARDS AND SPECIFICATIONS

NOTE: THE ENTIRE RIVERBEND APARTMENTS STORM SEWER SYSTEM WAS DESIGNED USING THE 10-YR STORM EVENT TO CONTAIN THE RUNOFF WITHIN THE PIPE AND STRUCTURES. IN ADDITION, THE 100-YR STORM EVENT WAS ROUTED THROUGH THE STORM SYSTEM. THE STORM SEWER SYSTEM ADEQUATELY CONTAINED THE 100-YR STORM HGL WITH LITTLE TO NO PONDING OUTSIDE OF STRUCTURES AND DOES NOT IMPACT THE APARTMENT BUILDINGS.

ADA GRADING
MODIFICATIONS
03/15/19

RFI #8 - GRADING AND DRAINAGE
MODIFICATIONS 12/11/18

ALL SIDEWALKS SHALL HAVE A
MAXIMUM RUNNING SLOPE OF
5% AND A MAXIMUM CROSS
SLOPE OF 2%.

- LEGEND:
- ⊕ IRON ROD FOUND OR
 - ⊕ IRON PIPE FOUND
 - ⊕ CONCRETE MONUMENT FOUND
 - ⊕ IRON ROD OR PIPE SET
 - ⊕ CONCRETE MONUMENT SET
 - ⊕ TELEPHONE JUNCTION BOX
 - ⊕ OVERHEAD UTILITY LINE
 - N/F NOW OR FORMERLY
 - R/W RIGHT-OF-WAY
 - PP POWER POLE
 - EXISTING OVERHEAD UTILITY LINES
 - EP EDGE OF PAVEMENT
 - FC FACE OF CURB
 - TC TOP OF CURB
 - SW SIDEWALK
 - DS DOWNSPOUT
 - RD ROOF DRAIN
 - EC EDGE OF CONCRETE

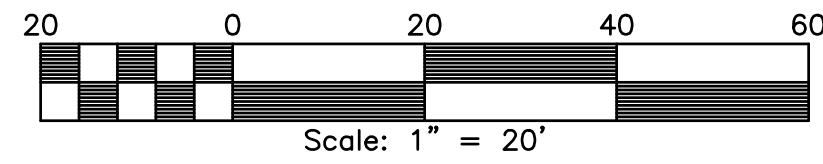

JOB NO. 12211-14

THIS DRAWING IS THE PROPERTY OF BAY DESIGN GROUP AND IS NOT TO BE REPRODUCED OR USED FOR ANY PROJECT IN WHOLE OR IN PART WITHOUT EXPRESS WRITTEN PERMISSION.

PROJECT MANAGER: GLJ
DESIGNED: WAS
CAD: WAS
CHECKED: WBB

FILED:
DATE: JANUARY 10, 2018
REVISED: APRIL 20, 2018
REVISED: JUNE 25, 2018
REVISED: JULY 13, 2018
REVISED: JULY 18, 2018
REVISED: AUGUST 27, 2018

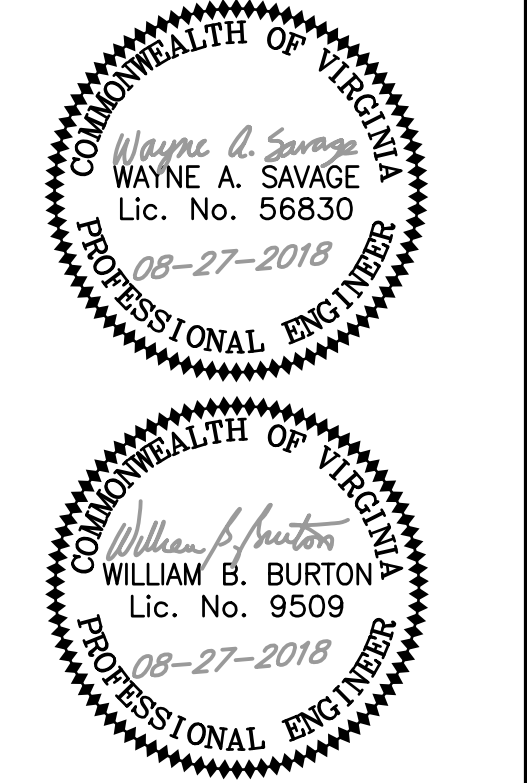

PROJECT: RIVERBEND APARTMENTS

ABINGDON DISTRICT
GLOUCESTER, VIRGINIA

SHEET: DETAILED GRADING PLAN

SHEET NO: C11
JOB NO. 12211-14